

Pulegge per cinghie dentate tipo export

Timing belt pulleys for export

Zahnriemenscheiben für export

Poulies pour courroies dentées pour exportation

Poleas para correas dentadas para exportacion

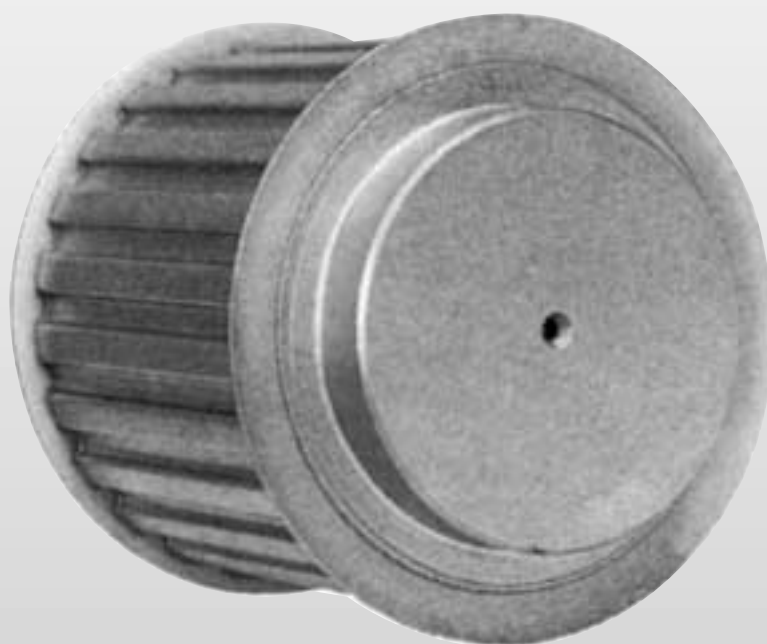

Pulegge per cinghie dentate tipo export
Timing belt pulleys for export
Zahnriemenscheiben für export
Poules pour courroies dentées pour exportation
Poleas para correas para exportacion

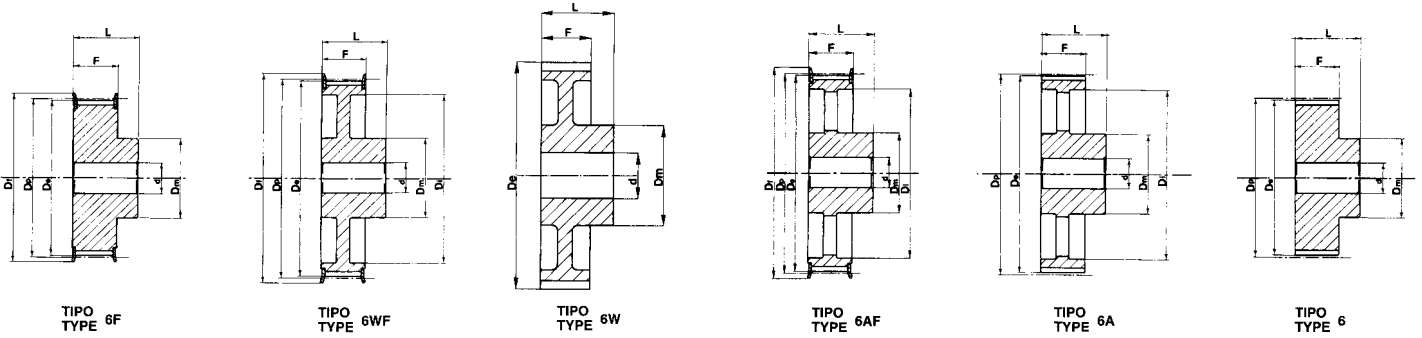

XL 037 - 1/5" (5,08 mm)

| CARATTERISTICHE FEATURES MERKMALE CARACTERISTIQUES CARACTERISTICAS | | CODICE CODE SYMBOL FABRIKNUMMER CODE SYMBOLE NUMERO DE FABRICA | NOSTRO CODICE OUR CODE UNSER KODE NOTRE CODE NUESTRO CODIGO | TIPO TYPE TYP TYPE TIPO | TIPO FLANGIA FLANGES TYPE BORDSCHE IBEN TYP TYPE FLASQUES TIPO TAPETAS | N. DENTI N. OF TEETH ZAHNEZAHL N. BRE DE DENTS CANTIDAD DE DIENTES | Dp | De | Df | Dm | Di | F | L | E | FORO STOCK STOCK BORE VOR BOHRUNG ALESAGE EN STOCK AGUJERO DE STOCK | FORO MAX. MAX. BORE MAX. BOHRUNG ALESAGE EN MAX AGUJERO DE MAX | FORO FILETTATO SETSCHREW FESTSELL- SCHRAUBE VIS DE BLOCAGE TORNILLO DE BLOQUEO | PESO WEIGHT GEWICHT POIDS PESO Kg |
|--|---|---|---|-------------------------------------|---|--|--------|--------|----|------|------|------|------|------|--|---|---|--|
| ACCIAIO STEEL STAHL ACIER ACERO | CON FLANGIA WITH FLANGES MIT FLANGES AVEC FLASQUES CON TAPETAS | 10 XL 037 | EX 37010 | 6F | F07 | 10 | 16,17 | 15,66 | 23 | 9,5 | - | 14,3 | 19,8 | - | 4,0 | 6,4 | M 3 | 0,02 |
| | | 11 XL 037 | EX 37011 | 6F | F07 | 11 | 17,79 | 17,28 | 23 | 11,1 | - | 14,3 | 19,8 | - | 4,0 | 6,4 | M 3 | 0,02 |
| | | 12 XL 037 | EX 37012 | 6F | F08 | 12 | 19,40 | 18,90 | 25 | 12,7 | - | 14,3 | 19,8 | - | 4,0 | 7,9 | M 3 | 0,03 |
| | | 14 XL 037 | EX 37014 | 6F | F09 | 14 | 22,64 | 22,13 | 28 | 14,3 | - | 14,3 | 19,8 | - | 6,0 | 9,5 | M 4 | 0,04 |
| | | 15 XL 037 | EX 37015 | 6F | F09 | 15 | 24,26 | 23,75 | 28 | 15,9 | - | 14,3 | 19,8 | - | 6,0 | 11,1 | M 4 | 0,07 |
| | | 16 XL 037 | EX 37016 | 6F | F10 | 16 | 25,87 | 25,36 | 32 | 17,5 | - | 14,3 | 19,8 | - | 6,0 | 12,7 | M 4 | 0,05 |
| | | 18 XL 037 | EX 37018 | 6F | F11 | 18 | 29,11 | 28,60 | 35 | 20,6 | - | 14,3 | 29,8 | - | 6,0 | 14,3 | M 4 | 0,06 |
| | | 20 XL 037 | EX 37020 | 6F | F14 | 20 | 32,34 | 31,83 | 38 | 23,8 | - | 14,3 | 22,2 | - | 6,0 | 17,5 | M 4 | 0,08 |
| | | 21 XL 037 | EX 37021 | 6F | F14 | 21 | 33,96 | 33,45 | 38 | 23,8 | - | 14,3 | 22,2 | - | 6,0 | 17,5 | M 4 | 0,09 |
| | | 22 XL 037 | EX 37022 | 6F | F15 | 22 | 35,57 | 35,07 | 41 | 25,4 | - | 14,3 | 22,2 | - | 6,0 | 19,1 | M 4 | 0,10 |
| | | 24 XL 037 | EX 37024 | 6F | F17 | 24 | 38,81 | 38,30 | 44 | 27,0 | - | 14,3 | 22,2 | - | 6,0 | 20,6 | M 4 | 0,12 |
| | | 26 XL 037 | EX 37026 | 6F | F18 | 26 | 42,04 | 41,53 | 48 | 30,0 | - | 14,3 | 22,2 | - | 6,0 | 23,0 | M 4 | 0,14 |
| 28 XL 037 | EX 37028 | 6F | F19 | 28 | 45,28 | 44,77 | 51 | 30,2 | - | 14,3 | 22,2 | - | 6,0 | 23,0 | M 4 | 0,16 | | |
| 30 XL 037 | EX 37030 | 6F | F24 | 30 | 48,51 | 48,00 | 64 | 34,9 | - | 14,3 | 22,2 | - | 6,0 | 23,0 | M 4 | 0,19 | | |
| ALLUMINIO ALUMINIUM ALUMINIUM ALUMINIOM ALUMINIO | SENZA FLANGIA WITHOUT FLANGES OHNE FLANSCHEN SANS FLASQUES SINTAPETAS | 32 XL 037 | EX 37032 | 6 | | 32 | 51,74 | 51,24 | - | 38,0 | - | 14,3 | 25,4 | - | 8,0 | 23,0 | M 4 | 0,11 |
| | | 36 XL 037 | EX 37036 | 6 | | 36 | 58,21 | 57,70 | - | 38,0 | - | 14,3 | 25,4 | - | 8,0 | 23,0 | M 4 | 0,13 |
| | | 40 XL 037 | EX 37040 | 6 | | 40 | 64,68 | 64,17 | - | 38,0 | - | 14,3 | 25,4 | - | 8,0 | 23,0 | M 4 | 0,17 |
| | | 42 XL 037 | EX 37042 | 6W | | 42 | 67,91 | 67,41 | - | 38,0 | - | 14,3 | 25,4 | - | 8,0 | 23,0 | M 4 | 0,13 |
| | | 44 XL 037 | EX 37044 | 6W | | 44 | 71,15 | 70,64 | - | 38,0 | - | 14,3 | 25,4 | - | 8,0 | 23,0 | M 4 | 0,15 |
| | | 48 XL 037 | EX 37048 | 6W | | 48 | 77,62 | 77,11 | - | 38,0 | 61 | 14,3 | 25,4 | - | 8,0 | 23,0 | M 4 | 0,16 |
| | | 60 XL 037 | EX 37060 | 6A | | 60 | 97,02 | 96,51 | - | 38,0 | 80 | 14,3 | 25,4 | - | 8,0 | 23,0 | M 4 | 0,18 |
| | | 72 XL 037 | EX 37072 | 6A | | 72 | 116,43 | 115,92 | - | 38,0 | 100 | 14,3 | 25,4 | - | 8,0 | 23,0 | M 4 | 0,23 |

L 050 - 3/8" (9,525 mm)

| CARATTERISTICHE FEATURES MERKMALE CARACTERISTIQUES CARACTERISTICAS | | CODICE CODE SYMBOL FABRIKNUMMER CODE SYMBOLE NUMERO DE FABRICA | NOSTRO CODICE OUR CODE UNSER KODE NOTRE CODE NUESTRO CODIGO | TIPO TYPE TYP TYPE TIPO | TIPO FLANGIA FLANGES TYPE BORDSCHE IBEN TYP TYPE FLASQUES TIPO TAPETAS | N. DENTI N. OF TEETH ZAHNEZAHL N. BRE DE DENTS CANTIDAD DE DIENTES | Dp | De | Df | Dm | Di | F | L | E | FORO STOCK STOCK BORE VOR BOHRUNG ALESAGE EN STOCK AGUJERO DE STOCK | FORO MAX. MAX. BORE MAX. BOHRUNG ALESAGE EN MAX AGUJERO DE MAX | PESO WEIGHT GEWICHT POIDS PESO Kg |
|--|--|---|--|-------------------------------------|---|--|--------|--------|--------|--------|-----|----|-----|----|--|---|--|
| ACCIAIO STEEL STAHL ACIER ACERO | CON FLANGIA WITH FLANGES MIT FLANGES AVEC FLASQUES CON TAPETAS | 10 L 050 | EL 50010 | 6F | F13 | 10 | 30,32 | 29,56 | 37 | 22 | - | 19 | 26 | - | 6 | 13 | 0,11 |
| | | 12 L 050 | EL 50012 | 6F | F16 | 12 | 36,38 | 35,62 | 43 | 28 | - | 19 | 26 | - | 6 | 17 | 0,19 |
| | | 13 L 050 | EL 50013 | 6F | F17 | 13 | 39,41 | 38,65 | 44 | 30 | - | 19 | 26 | - | 6 | 19 | 0,21 |
| | | 14 L 050 | EL 50014 | 6F | F18 | 14 | 42,45 | 41,68 | 48 | 33 | - | 19 | 26 | - | 8 | 20 | 0,25 |
| | | 15 L 050 | EL 50015 | 6F | F19 | 15 | 45,48 | 44,72 | 51 | 36 | - | 19 | 26 | - | 8 | 23 | 0,30 |
| | | 16 L 050 | EL 50016 | 6F | F20 | 16 | 48,51 | 47,75 | 54 | 38 | - | 19 | 26 | - | 8 | 23 | 0,33 |
| | | 17 L 050 | EL 50017 | 6F | F21 | 17 | 51,54 | 50,78 | 57 | 40 | - | 19 | 26 | - | 10 | 24 | 0,36 |
| | | 18 L 050 | EL 50018 | 6F | F22 | 18 | 54,47 | 53,81 | 60 | 40 | - | 19 | 26 | - | 10 | 24 | 0,41 |
| | | 19 L 050 | EL 50019 | 6F | F24 | 19 | 57,61 | 56,84 | 64 | 40 | - | 19 | 26 | - | 10 | 24 | 0,45 |
| | | 20 L 050 | EL 50020 | 6F | F25 | 20 | 60,64 | 59,88 | 66 | 46 | - | 19 | 26 | - | 10 | 28 | 0,50 |
| | | 21 L 050 | EL 50021 | 6F | F26 | 21 | 63,67 | 62,91 | 70 | 46 | - | 19 | 26 | - | 10 | 28 | 0,55 |
| | | 22 L 050 | EL 50022 | 6F | F27 | 22 | 66,70 | 65,94 | 75 | 50 | - | 19 | 26 | - | 10 | 30 | 0,62 |
| | | 24 L 050 | EL 50024 | 6F | F28 | 24 | 72,77 | 72,00 | 79 | 50 | - | 19 | 26 | - | 12 | 30 | 0,68 |
| | | 26 L 050 | EL 50026 | 6F | F30 | 26 | 78,83 | 78,07 | 87 | 50 | - | 19 | 26 | - | 12 | 30 | 0,82 |
| | | 28 L 050 | EL 50028 | 6F | F31 | 28 | 84,89 | 84,13 | 91 | 50 | - | 19 | 26 | - | 12 | 30 | 0,92 |
| | | 30 L 050 | EL 50030 | 6F | F33 | 30 | 90,96 | 90,20 | 97 | 50 | - | 19 | 26 | - | 12 | 30 | 1,10 |
| | | 32 L 050 | EL 50032 | 6F | F34 | 32 | 97,02 | 96,26 | 102 | 50 | 85 | 19 | 26 | - | 12 | 30 | 1,20 |
| | | GHISA CAST IRON GUSSEISEN FONTEUS HIERRO FUNDIDO | SENZA FLANGIA WITHOUT FLANGES OHNE FLANSCHEN SANS FLASQUES SINTAPETAS | 36 L 050 | EL 50036 | 6WF | F37 | 36 | 109,15 | 108,39 | 115 | 50 | 100 | 19 | 26 | - | 12 |
| 40 L 050 | EL 50040 | | | 6WF | F40 | 40 | 121,28 | 120,51 | 128 | 50 | 100 | 19 | 26 | - | 12 | 30 | 1,10 |
| 44 L 050 | EL 50044 | | | 6AF | F45 | 44 | 133,40 | 132,64 | 142 | 50 | 112 | 19 | 26 | - | 12 | 30 | 1,20 |
| 48 L 050 | EL 50048 | | | 6AF | F48 | 48 | 145,53 | 144,77 | 150 | 50 | 124 | 19 | 26 | - | 12 | 30 | 1,30 |
| 60 L 050 | EL 50060 | | | 6A | | 60 | 191,91 | 181,15 | - | 50 | 160 | 19 | 28 | - | 15 | 30 | 1,30 |
| 72 L 050 | EL 50072 | | | 6A | | 72 | 218,30 | 217,53 | - | 50 | 197 | 19 | 28 | - | 15 | 30 | 1,70 |
| 84 L 050 | EL 50084 | | | 6A | | 84 | 254,68 | 253,92 | - | 50 | 233 | 19 | 28 | - | 15 | 30 | 1,90 |

Pulegge per cinghie dentate tipo export
Timing belt pulleys for export
Zahnriemenscheiben für export
Poulies pour courroies dentées pour exportation
Poleas para correas para exportacion

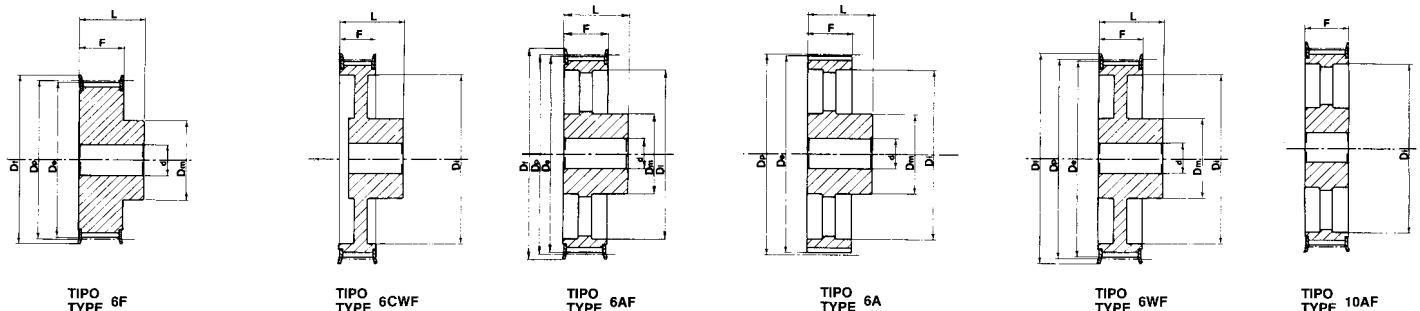

L 075 - 3/8" (9,525 mm)

| CARATTERISTICHE FEATURES MERKMALE CARACTERISTIQUES CARACTERISTICAS | | CODICE CODE SYMBOL FABRIKNUMMER CODE SYMBOLE NUMERO DE FABRICA | NOSTRO CODICE OUR CODE UNSER KODE NOTRE CODE NUESTRO CODIGO | TIPO TYPE TYP TYPE TIPO | TIPO FLANGIA FLANGES TYPE BORDSCHE IBEN TYP TYPE FLASQUES TIPO TAPETAS | N.DENTI N. OF TEETH ZAHNEZAHL N. BRE DE DENTS CANTIDAD DE DIENTES | Dp | De | Df | Dm | Di | F | L | E | FORO STOCK STOCK BORE VOR BOHRUNG ALESAGE EN STOCK AGUJERO DE STOCK | FORO MAX. MAX. BORE MAX. BOHRUNG ALESAGE EN MAX. AGUJERO DE MAX | PESO WEIGHT GEWICHT POIDS PESO Kg |
|--|--|---|---|-------------------------------------|---|---|--------|--------|-----|----|-----|----|----|---|--|--|--|
| ACCIAIO STEEL STAHL ACIER ACERO | CON FLANGIA WITH FLANGES MIT FLANGES AVEC FLASQUES CON TAPETAS | 12 L 075 | EL 75012 | 6F | F16 | 12 | 36,38 | 35,62 | 43 | 28 | - | 25 | 32 | - | 8 | 17 | 0,23 |
| | | 13 L 075 | EL 75013 | 6F | F17 | 13 | 39,41 | 38,65 | 44 | 30 | - | 25 | 32 | - | 8 | 19 | 0,26 |
| | | 14 L 075 | EL 75014 | 6F | F18 | 14 | 42,45 | 41,68 | 48 | 33 | - | 25 | 32 | - | 8 | 20 | 0,32 |
| | | 15 L 075 | EL 75015 | 6F | F19 | 15 | 45,48 | 44,72 | 51 | 36 | - | 25 | 32 | - | 8 | 23 | 0,35 |
| | | 16 L 075 | EL 75016 | 6F | F20 | 16 | 48,51 | 47,75 | 54 | 38 | - | 25 | 32 | - | 8 | 23 | 0,42 |
| | | 17 L 075 | EL 75017 | 6F | F21 | 17 | 51,54 | 50,78 | 57 | 40 | - | 25 | 32 | - | 10 | 24 | 0,45 |
| | | 18 L 075 | EL 75018 | 6F | F22 | 18 | 54,57 | 53,81 | 60 | 40 | - | 25 | 32 | - | 10 | 24 | 0,51 |
| | | 19 L 075 | EL 75019 | 6F | F24 | 19 | 57,61 | 56,84 | 64 | 40 | - | 25 | 32 | - | 10 | 24 | 0,57 |
| | | 20 L 075 | EL 75020 | 6F | F25 | 20 | 60,64 | 59,88 | 66 | 46 | - | 25 | 32 | - | 10 | 28 | 0,63 |
| | | 21 L 075 | EL 75021 | 6F | F26 | 21 | 63,67 | 62,91 | 70 | 46 | - | 25 | 32 | - | 10 | 28 | 0,70 |
| | | 22 L 075 | EL 75022 | 6F | F27 | 22 | 66,70 | 65,94 | 75 | 50 | - | 25 | 32 | - | 10 | 30 | 0,75 |
| | | 24 L 075 | EL 75024 | 6F | F28 | 24 | 72,77 | 72,00 | 79 | 50 | - | 25 | 32 | - | 12 | 30 | 0,85 |
| | | 26 L 075 | EL 75026 | 6F | F30 | 26 | 78,83 | 78,07 | 87 | 50 | - | 25 | 32 | - | 12 | 30 | 1,00 |
| | | 28 L 075 | EL 75028 | 6F | F31 | 28 | 84,89 | 84,13 | 91 | 50 | - | 25 | 32 | - | 12 | 30 | 1,20 |
| | | 30 L 075 | EL 75030 | 6F | F33 | 30 | 90,96 | 90,20 | 97 | 50 | - | 25 | 32 | - | 12 | 30 | 1,40 |
| | | 32 L 075 | EL 75032 | 6F | F34 | 32 | 97,02 | 96,26 | 102 | 50 | - | 25 | 32 | - | 12 | 30 | 1,50 |
| GHISA CAST IRON GRAUGUSS FONTE HIERRO FUNDIDO | CON FLANGIA WITH FLANGES MIT FLANGES AVEC FLASQUES CON TAPETAS | 36 L 075 | EL 75036 | 6WF | F37 | 36 | 109,15 | 108,39 | 115 | 55 | 85 | 25 | 32 | - | 12 | 32 | 1,30 |
| | | 40 L 075 | EL 75040 | 6WF | F40 | 40 | 121,28 | 120,51 | 128 | 60 | 100 | 25 | 32 | - | 12 | 35 | 1,60 |
| | | 44 L 075 | EL 75044 | 6AF | F45 | 44 | 133,40 | 132,64 | 142 | 60 | 112 | 25 | 32 | - | 12 | 35 | 1,70 |
| | | 48 L 075 | EL 75048 | 6AF | F48 | 48 | 145,53 | 144,79 | 150 | 60 | 124 | 25 | 32 | - | 12 | 35 | 1,90 |
| | SENZA FLANGIA WITHOUT FLANGES OHNE FLANSCHEN SANS FLASQUES SIN TAPETAS | 60 L 100 | EL 75060 | 6A | | 60 | 181,91 | 181,15 | - | 60 | 160 | 26 | 35 | - | 15 | 35 | 1,80 |
| | | 72 L 100 | EL 75072 | 6A | | 72 | 218,30 | 217,53 | - | 60 | 197 | 26 | 35 | - | 15 | 35 | 2,30 |
| | | 84 L 100 | EL 75084 | 6A | | 84 | 254,68 | 253,92 | - | 60 | 233 | 26 | 35 | - | 15 | 35 | 2,50 |

L 100 - 3/8" (9,525 mm)

| CARATTERISTICHE FEATURES MERKMALE CARACTERISTIQUES CARACTERISTICAS | | CODICE CODE SYMBOL FABRIKNUMMER CODE SYMBOLE NUMERO DE FABRICA | NOSTRO CODICE OUR CODE UNSER KODE NOTRE CODE NUESTRO CODIGO | TIPO TYPE TYP TYPE TIPO | TIPO FLANGIA FLANGES TYPE BORDSCHE IBEN TYP TYPE FLASQUES TIPO TAPETAS | N.DENTI N. OF TEETH ZAHNEZAHL N. BRE DE DENTS CANTIDAD DE DIENTES | Dp | De | Df | Dm | Di | F | L | E | FORO STOCK STOCK BORE VOR BOHRUNG ALESAGE EN STOCK AGUJERO DE STOCK | FORO MAX. MAX. BORE MAX. BOHRUNG ALESAGE EN MAX. AGUJERO DE MAX | PESO WEIGHT GEWICHT POIDS PESO Kg |
|--|--|---|---|-------------------------------------|---|---|--------|--------|-----|----|-----|----|----|---|--|--|--|
| ACCIAIO STEEL STAHL ACIER ACERO | CON FLANGIA WITH FLANGES MIT FLANGES AVEC FLASQUES CON TAPETAS | 12 L 150 | EL 10012 | 6F | F16 | 12 | 36,38 | 35,62 | 43 | 28 | - | 31 | 38 | - | 8 | 17 | 0,29 |
| | | 13 L 150 | EL 10013 | 6F | F17 | 13 | 39,41 | 38,65 | 44 | 30 | - | 31 | 38 | - | 8 | 19 | 0,28 |
| | | 14 L 150 | EL 10014 | 6F | F18 | 14 | 42,45 | 41,68 | 48 | 33 | - | 31 | 38 | - | 8 | 20 | 0,38 |
| | | 15 L 150 | EL 10015 | 6F | F19 | 15 | 45,48 | 44,72 | 51 | 36 | - | 31 | 38 | - | 8 | 23 | 0,40 |
| | | 16 L 150 | EL 10016 | 6F | F20 | 16 | 48,51 | 47,75 | 54 | 38 | - | 31 | 38 | - | 8 | 23 | 0,51 |
| | | 17 L 150 | EL 10017 | 6F | F21 | 17 | 51,54 | 50,78 | 57 | 40 | - | 31 | 38 | - | 10 | 24 | 0,54 |
| | | 18 L 150 | EL 10018 | 6F | F22 | 18 | 54,57 | 53,81 | 60 | 40 | - | 31 | 38 | - | 10 | 24 | 0,62 |
| | | 19 L 150 | EL 10019 | 6F | F24 | 19 | 57,61 | 56,84 | 64 | 40 | - | 31 | 38 | - | 10 | 24 | 0,69 |
| | | 20 L 150 | EL 10020 | 6F | F25 | 20 | 60,64 | 59,88 | 66 | 46 | - | 31 | 38 | - | 10 | 28 | 0,76 |
| | | 21 L 150 | EL 10021 | 6F | F26 | 21 | 63,67 | 62,91 | 70 | 46 | - | 31 | 38 | - | 10 | 28 | 0,82 |
| | | 22 L 150 | EL 10022 | 6F | F27 | 22 | 66,70 | 65,94 | 75 | 50 | - | 31 | 38 | - | 10 | 30 | 0,92 |
| | | 24 L 150 | EL 10024 | 6F | F28 | 24 | 72,77 | 72,00 | 79 | 50 | - | 31 | 38 | - | 12 | 30 | 1,10 |
| | | 26 L 150 | EL 10026 | 6F | F30 | 26 | 78,83 | 78,07 | 87 | 50 | - | 31 | 38 | - | 12 | 30 | 1,30 |
| | | 28 L 150 | EL 10028 | 6F | F31 | 28 | 84,89 | 84,13 | 91 | 50 | - | 31 | 38 | - | 12 | 30 | 1,40 |
| | | 30 L 150 | EL 10030 | 6F | F33 | 30 | 90,96 | 90,20 | 97 | 50 | - | 31 | 38 | - | 12 | 30 | 1,70 |
| | | 32 L 150 | EL 10032 | 6F | F34 | 32 | 97,02 | 96,26 | 102 | 50 | - | 31 | 38 | - | 12 | 30 | 1,80 |
| GHISA CAST IRON GRAUGUSS FONTE HIERRO FUNDIDO | SENZA FLANGIA WITHOUT FLANGES OHNE FLANSCHEN SANS FLASQUES SIN TAPETAS | 36 L 150 | EL 10036 | 6WF | F37 | 36 | 109,15 | 108,39 | 115 | 55 | 85 | 32 | 38 | 6 | 12 | 32 | 1,50 |
| | | 40 L 150 | EL 10040 | 6WF | F40 | 40 | 121,28 | 120,51 | 128 | 60 | 100 | 32 | 38 | 6 | 12 | 35 | 1,80 |
| | | 44 L 150 | EL 10044 | 10AF | F45 | 44 | 133,40 | 132,64 | 142 | 60 | 112 | 32 | - | - | 12 | 35 | 1,90 |
| | | 48 L 150 | EL 10048 | 10AF | F48 | 48 | 145,53 | 144,79 | 150 | 60 | 124 | 32 | - | - | 12 | 35 | 2,10 |

Pulegge per cinghie dentate tipo export
Timing belt pulleys for export
Zahnriemenscheiben für export
Poulies pour courroies dentées pour exportation
Poleas para correas para exportacion

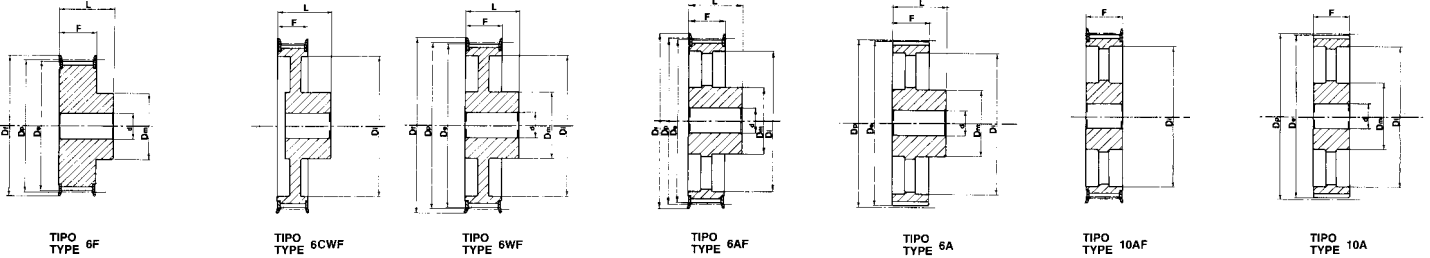

H 100 - 1/2" (12,7 mm)

| CARATTERISTICHE FEATURES MERKMALE CARACTERISTIQUES CARACTERISTICAS | | CODICE CODE SYMBOL FABRIKNUMMER CODE SYMBOLE NUMERO DE FABRICA | NOSTRO CODICE OUR CODE UNSER KODE NOTRE CODE NUESTRO CODIGO | TIPO TYPE TYP TYPE TIPO | TIPO FLANGIA FLANGES TYPE BORDSCHE IBEN TYP TYPE FLASQUES TIPO TAPETAS | N.DENTI N. OF TEETH ZAHNEZAHL N. BRE DE DENTS CANTIDAD DE DIENTES | Dp | De | Df | Dm | Di | F | L | E | FORO STOCK STOCK BORE VOR BOHRUNG ALESAGE EN STOCK AGUJERO DE STOCK | FORO MAX. MAX. BORE MAX. BOHRUNG ALESAGE EN MAX. AGUJERO DE MAX | PESO WEIGHT GEWICHT POIDS PESO Kg |
|--|--|---|---|-------------------------------------|---|---|--------|--------|-----|----|-----|----|----|----|--|--|--|
| ACCIAIO STEEL STAHL ACIER ACERO | CON FLANGIA WITH FLANGES MIT FLANGES AVEC FLASQUES CON TAPETAS | 14 H 100 | EH 10014 | 6F | F24 | 14 | 56,60 | 55,22 | 64 | 40 | - | 31 | 41 | - | 10 | 24 | 0,65 |
| | | 16 H 100 | EH 10016 | 6F | F26 | 16 | 64,68 | 63,31 | 70 | 46 | - | 31 | 41 | - | 10 | 28 | 0,85 |
| | | 18 H 100 | EH 10018 | 6F | F28 | 18 | 72,77 | 71,39 | 79 | 54 | - | 31 | 41 | - | 12 | 32 | 1,10 |
| | | 19 H 100 | EH 10019 | 6F | F29 | 19 | 76,81 | 75,44 | 83 | 58 | - | 31 | 41 | - | 12 | 34 | 1,20 |
| | | 20 H 100 | EH 10020 | 6F | F30 | 20 | 80,85 | 79,48 | 87 | 62 | - | 31 | 41 | - | 12 | 35 | 1,40 |
| | | 21 H 100 | EH 10021 | 6F | F31 | 21 | 84,89 | 83,52 | 91 | 67 | - | 31 | 41 | - | 12 | 38 | 1,60 |
| | | 22 H 100 | EH 10022 | 6F | F32 | 22 | 88,94 | 87,56 | 93 | 70 | - | 31 | 41 | - | 12 | 41 | 1,70 |
| | | 24 H 100 | EH 10024 | 6F | F34 | 24 | 97,02 | 95,65 | 102 | 75 | - | 31 | 41 | - | 12 | 45 | 2,00 |
| | | 26 H 100 | EH 10026 | 6CWF | F36 | 26 | 105,11 | 103,73 | 112 | 55 | 81 | 32 | 40 | 8 | 15 | 32 | 1,40 |
| | | 28 H 100 | EH 10028 | 6CWF | F38 | 28 | 113,19 | 111,82 | 120 | 60 | 88 | 32 | 40 | 8 | 15 | 35 | 1,60 |
| | | 30 H 100 | EH 10030 | 6CWF | F40 | 30 | 121,28 | 119,90 | 128 | 60 | 97 | 32 | 40 | 8 | 15 | 35 | 1,70 |
| | | 32 H 100 | EH 10032 | 6WF | F42 | 32 | 129,36 | 127,99 | 135 | 70 | 105 | 32 | 40 | - | 20 | 40 | 2,20 |
| 36 H 100 | EH 10036 | 6WF | F48 | 36 | 145,53 | 144,16 | 150 | 80 | 118 | 32 | 40 | - | 20 | 45 | 3,00 | | |
| GHISA CAST IRON GRAUGUSS FONTE HIERRO FUNDIDO | SENZA FLANGIA WITHOUT FLANGES OHNE FLANSCHEN SANS FLASQUES SINTAPETAS | 40 H 100 | EH 10040 | 6AF | F52 | 40 | 161,70 | 160,33 | 168 | 80 | 135 | 32 | 40 | - | 20 | 45 | 2,80 |
| | | 44 H 100 | EH 10044 | 6AF | F55 | 44 | 177,87 | 176,50 | 184 | 80 | 150 | 32 | 40 | - | 20 | 45 | 3,10 |
| | | 48 H 100 | EH 10048 | 6AF | F59 | 48 | 194,04 | 192,67 | 200 | 80 | 170 | 32 | 40 | - | 20 | 45 | 3,30 |
| | | 60 H 100 | EH 10060 | 6A | F60 | 60 | 242,55 | 241,18 | - | 85 | 216 | 34 | 45 | - | 20 | 48 | 5,50 |
| | | 72 H 100 | EH 10072 | 6A | F72 | 72 | 291,06 | 289,69 | - | 85 | 263 | 34 | 45 | - | 20 | 48 | 7,10 |
| | | 84 H 100 | EH 10084 | 6A | F84 | 84 | 339,57 | 338,20 | - | 85 | 312 | 34 | 45 | - | 20 | 48 | 8,20 |
| | | 96 H 100 | EH 10096 | 6A | F96 | 96 | 338,08 | 386,71 | - | 85 | 360 | 34 | 45 | - | 20 | 48 | 9,90 |
| | | 120 H 100 | EH 10120 | 6A | F120 | 120 | 485,10 | 483,73 | - | 90 | 458 | 34 | 50 | - | 20 | 55 | 13,10 |

H 150 - 1/2" (12,7 mm)

| CARATTERISTICHE FEATURES MERKMALE CARACTERISTIQUES CARACTERISTICAS | | CODICE CODE SYMBOL FABRIKNUMMER CODE SYMBOLE NUMERO DE FABRICA | NOSTRO CODICE OUR CODE UNSER KODE NOTRE CODE NUESTRO CODIGO | TIPO TYPE TYP TYPE TIPO | TIPO FLANGIA FLANGES TYPE BORDSCHE IBEN TYP TYPE FLASQUES TIPO TAPETAS | N.DENTI N. OF TEETH ZAHNEZAHL N. BRE DE DENTS CANTIDAD DE DIENTES | Dp | De | Df | Dm | Di | F | L | E | FORO STOCK STOCK BORE VOR BOHRUNG ALESAGE EN STOCK AGUJERO DE STOCK | FORO MAX. MAX. BORE MAX. BOHRUNG ALESAGE EN MAX. AGUJERO DE MAX | PESO WEIGHT GEWICHT POIDS PESO Kg |
|--|--|---|---|-------------------------------------|---|---|--------|--------|-----|----|-----|----|----|----|--|--|--|
| ACCIAIO STEEL STAHL ACIER ACERO | CON FLANGIA WITH FLANGES MIT FLANGES AVEC FLASQUES CON TAPETAS | 14 H 150 | EH 15014 | 6F | F24 | 14 | 56,60 | 55,22 | 64 | 40 | - | 44 | 54 | - | 10 | 24 | 0,82 |
| | | 16 H 150 | EH 15016 | 6F | F26 | 16 | 64,68 | 63,31 | 70 | 46 | - | 44 | 54 | - | 10 | 28 | 1,10 |
| | | 18 H 150 | EH 15018 | 6F | F28 | 18 | 72,77 | 71,39 | 79 | 54 | - | 44 | 54 | - | 12 | 32 | 1,50 |
| | | 19 H 150 | EH 15019 | 6F | F29 | 19 | 76,81 | 75,44 | 83 | 58 | - | 44 | 54 | - | 12 | 34 | 1,70 |
| | | 20 H 150 | EH 15020 | 6F | F30 | 20 | 80,85 | 79,48 | 87 | 62 | - | 44 | 54 | - | 12 | 35 | 1,80 |
| | | 21 H 150 | EH 15021 | 6F | F31 | 21 | 84,89 | 83,52 | 91 | 67 | - | 44 | 54 | - | 12 | 38 | 2,20 |
| | | 22 H 150 | EH 15022 | 6F | F32 | 22 | 88,94 | 87,56 | 93 | 70 | - | 44 | 54 | - | 12 | 41 | 2,30 |
| | | 24 H 150 | EH 15024 | 6F | F34 | 24 | 97,02 | 95,65 | 102 | 75 | - | 44 | 54 | - | 12 | 45 | 2,60 |
| | | 26 H 150 | EH 15026 | 6CWF | F36 | 26 | 105,11 | 103,73 | 112 | 55 | 81 | 45 | 53 | 8 | 15 | 32 | 1,70 |
| | | 28 H 150 | EH 15028 | 6CWF | F38 | 28 | 113,19 | 111,82 | 120 | 60 | 88 | 45 | 53 | 8 | 15 | 35 | 1,90 |
| | | 30 H 150 | EH 15030 | 6CWF | F40 | 30 | 121,28 | 119,90 | 128 | 60 | 97 | 45 | 53 | 8 | 15 | 35 | 2,10 |
| | | 32 H 150 | EH 15032 | 6WF | F42 | 32 | 129,36 | 127,99 | 135 | 70 | 105 | 45 | 53 | - | 20 | 40 | 2,60 |
| 36 H 150 | EH 15036 | 6WF | F48 | 36 | 145,53 | 144,16 | 150 | 80 | 118 | 45 | 53 | - | 20 | 45 | 3,20 | | |
| GHISA CAST IRON GRAUGUSS FONTE HIERRO FUNDIDO | SENZA FLANGIA WITHOUT FLANGES OHNE FLANSCHEN SANS FLASQUES SINTAPETAS | 40 H 150 | EH 15040 | 6AF | F52 | 40 | 161,70 | 160,33 | 168 | 80 | 135 | 45 | - | - | 20 | 45 | 3,80 |
| | | 44 H 150 | EH 15044 | 6AF | F55 | 44 | 177,87 | 176,50 | 184 | 80 | 150 | 45 | - | - | 20 | 45 | 3,70 |
| | | 48 H 150 | EH 15048 | 6AF | F59 | 48 | 194,04 | 192,67 | 200 | 80 | 170 | 45 | - | - | 20 | 45 | 4,00 |
| | | 60 H 150 | EH 15060 | 10A | F60 | 60 | 242,55 | 241,18 | - | 85 | 216 | 46 | - | - | 20 | 48 | 5,10 |
| | | 72 H 150 | EH 15072 | 10A | F72 | 72 | 291,06 | 289,69 | - | 85 | 263 | 46 | - | - | 20 | 48 | 7,90 |
| | | 84 H 150 | EH 15084 | 10A | F84 | 84 | 339,57 | 338,20 | - | 85 | 312 | 46 | - | - | 20 | 48 | 8,90 |
| | | 96 H 150 | EH 15096 | 10A | F96 | 96 | 338,08 | 386,71 | - | 85 | 360 | 46 | - | - | 20 | 48 | 10,10 |
| | | 120 H 150 | EH 15120 | 6A | F120 | 120 | 485,10 | 483,73 | - | 95 | 458 | 46 | 55 | - | 24 | 55 | 17,20 |

Pulegge per cinghie dentate tipo export
Timing belt pulleys for export
Zahnriemenscheiben für export
Poules pour courroies dentées pour exportation
Poleas para correas para exportacion

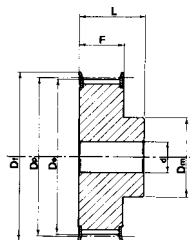

TIPO
TYPE 6F

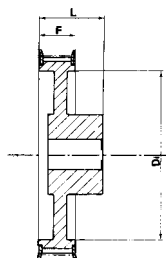

TIPO
TYPE 6CWF

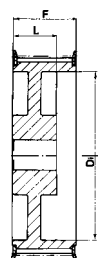

TIPO
TYPE 11 AF

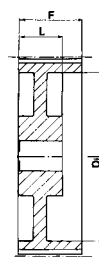

TIPO
TYPE 11 A

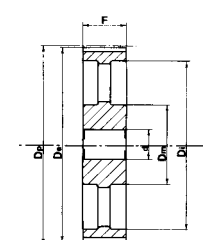

TIPO
TYPE 10A

H 200 - 1/2" (12,7 mm)

| CARATTERISTICHE FEATURES MERKMALE CARACTERISTIQUES CARACTERISTICAS | | CODICE CODE SYMBOL FABRIKNUMMER CODE SYMBOLE NUMERO DE FABRICA | NOSTRO CODICE OUR CODE UNSER KODE NOTRE CODE NUESTRO CODIGO | TIPO TYPE TYP TYPE TIPO | TIPO FLANGIA FLANGES TYPE BORDSCHE IBEN TYP TYPE FLASQUES TIPO TAPETAS | N. DENTI N. OF TEETH ZAHNEZAHL N. BRE DE DENTS CANTIDAD DE DIENTES | Dp | De | Df | Dm | Di | F | L | E | FORO STOCK STOCK BORE VOR BOHRUNG ALESAGE EN STOCK AGUJERO DE STOCK | FORO MAX. MAX. BORE MAX. BOHRUNG ALESAGE EN MAX. AGUJERO DE MAX | PESO WEIGHT GEWICHT POIDS PESO Kg |
|--|--|---|---|-------------------------------------|---|--|--------|--------|-----|----|-----|----|----|----|--|--|--|
| ACCIAIO STEEL STAHL ACIER ACERO | CON FLANGIA WITH FLANGES MIT FLANGES AVEC FLASQUES CON TAPETAS | 14 H 200 | EH 20014 | 6F | F24 | 14 | 56,60 | 55,22 | 64 | 40 | - | 58 | 68 | - | 12 | 24 | 1,10 |
| | | 16 H 200 | EH 20016 | 6F | F26 | 16 | 64,68 | 63,31 | 70 | 46 | - | 58 | 68 | - | 15 | 28 | 1,40 |
| | | 18 H 200 | EH 20018 | 6F | F28 | 18 | 72,77 | 71,39 | 79 | 54 | - | 58 | 68 | - | 15 | 32 | 1,80 |
| | | 19 H 200 | EH 20019 | 6F | F29 | 19 | 76,81 | 75,44 | 83 | 58 | - | 58 | 68 | - | 15 | 34 | 2,10 |
| | | 20 H 200 | EH 20020 | 6F | F30 | 20 | 80,85 | 79,48 | 87 | 62 | - | 58 | 68 | - | 15 | 35 | 2,30 |
| | | 21 H 200 | EH 20021 | 6F | F31 | 21 | 84,89 | 83,52 | 91 | 67 | - | 58 | 68 | - | 15 | 38 | 2,60 |
| | | 22 H 200 | EH 20022 | 6F | F32 | 22 | 88,94 | 87,56 | 93 | 70 | - | 58 | 68 | - | 15 | 41 | 2,80 |
| | | 24 H 200 | EH 20024 | 6F | F34 | 24 | 97,02 | 95,65 | 102 | 75 | - | 58 | 68 | - | 15 | 45 | 3,40 |
| | | 26 H 200 | EH 20026 | 6CWF | F36 | 26 | 105,11 | 103,73 | 112 | 55 | 81 | 58 | 66 | 24 | 15 | 32 | 2,30 |
| | | 28 H 200 | EH 20028 | 6CWF | F38 | 28 | 113,19 | 111,82 | 120 | 60 | 88 | 58 | 66 | 24 | 15 | 35 | 2,50 |
| | | 30 H 200 | EH 20030 | 6CWF | F40 | 30 | 121,28 | 119,90 | 128 | 60 | 97 | 58 | 66 | 24 | 15 | 35 | 2,90 |
| | | 32 H 200 | EH 20032 | 6CWF | F42 | 32 | 129,36 | 127,99 | 135 | 70 | 105 | 58 | 66 | 19 | 20 | 40 | 3,20 |
| 36 H 200 | EH 20036 | 6CWF | F48 | 36 | 145,53 | 144,16 | 150 | 80 | 118 | 58 | 66 | 19 | 20 | 45 | 3,80 | | |
| GHISA CAST IRON GRAUGUSS FONTE HIERRO FUNDIDO | SENZA FLANGIA WITHOUT FLANGES OHNE FLANSCHEN SANS FLASQUES SINTAPETAS | 40 H 200 | EH 20040 | 11AF | F52 | 40 | 161,70 | 160,33 | 168 | 80 | 135 | 58 | 45 | - | 20 | 45 | 4,10 |
| | | 44 H 200 | EH 20044 | 11AF | F55 | 44 | 177,87 | 176,50 | 184 | 80 | 150 | 58 | 45 | - | 20 | 45 | 4,40 |
| | | 48 H 200 | EH 20048 | 11AF | F59 | 48 | 194,04 | 192,67 | 200 | 80 | 170 | 58 | 45 | - | 20 | 48 | 5,10 |
| | | 60 H 200 | EH 20060 | 11A | | 60 | 242,55 | 241,18 | - | 85 | 216 | 60 | 50 | - | 20 | 50 | 7,10 |
| | | 72 H 200 | EH 20072 | 11A | | 72 | 291,06 | 289,69 | - | 85 | 263 | 60 | 50 | - | 20 | 50 | 8,00 |
| | | 84 H 200 | EH 20084 | 11A | | 84 | 339,57 | 338,20 | - | 85 | 312 | 60 | 50 | - | 20 | 50 | 12,00 |
| | | 96 H 200 | EH 20096 | 11A | | 96 | 338,08 | 386,71 | - | 85 | 360 | 60 | 50 | - | 20 | 50 | 13,60 |
| | | 120 H 200 | EH 20120 | 10A | | 120 | 485,10 | 483,73 | - | 85 | 458 | 60 | - | - | 24 | 57 | 16,60 |

H 300 - 1/2" (12,7 mm)

| CARATTERISTICHE FEATURES MERKMALE CARACTERISTIQUES CARACTERISTICAS | | CODICE CODE SYMBOL FABRIKNUMMER CODE SYMBOLE NUMERO DE FABRICA | NOSTRO CODICE OUR CODE UNSER KODE NOTRE CODE NUESTRO CODIGO | TIPO TYPE TYP TYPE TIPO | TIPO FLANGIA FLANGES TYPE BORDSCHE IBEN TYP TYPE FLASQUES TIPO TAPETAS | N. DENTI N. OF TEETH ZAHNEZAHL N. BRE DE DENTS CANTIDAD DE DIENTES | Dp | De | Df | Dm | Di | F | L | E | FORO STOCK STOCK BORE VOR BOHRUNG ALESAGE EN STOCK AGUJERO DE STOCK | FORO MAX. MAX. BORE MAX. BOHRUNG ALESAGE EN MAX. AGUJERO DE MAX | PESO WEIGHT GEWICHT POIDS PESO Kg |
|--|--|---|---|-------------------------------------|---|--|--------|--------|-----|----|-----|----|----|----|--|--|--|
| ACCIAIO STEEL STAHL ACIER ACERO | CON FLANGIA WITH FLANGES MIT FLANGES AVEC FLASQUES CON TAPETAS | 16 H 300 | EH 30016 | 6F | F24 | 16 | 64,68 | 63,31 | 64 | 46 | - | 84 | 94 | - | 15 | 28 | 2,00 |
| | | 18 H 300 | EH 30018 | 6F | F26 | 18 | 72,77 | 71,39 | 70 | 54 | - | 84 | 94 | - | 15 | 32 | 2,60 |
| | | 19 H 300 | EH 30019 | 6F | F28 | 19 | 76,81 | 75,44 | 79 | 58 | - | 84 | 94 | - | 15 | 34 | 2,90 |
| | | 20 H 300 | EH 30020 | 6F | F29 | 20 | 80,85 | 79,48 | 83 | 62 | - | 84 | 94 | - | 15 | 35 | 3,20 |
| | | 21 H 300 | EH 30021 | 6F | F30 | 21 | 84,89 | 83,52 | 87 | 67 | - | 84 | 94 | - | 15 | 38 | 3,60 |
| | | 22 H 300 | EH 30022 | 6F | F31 | 22 | 88,94 | 87,56 | 91 | 70 | - | 84 | 94 | - | 15 | 41 | 4,00 |
| | | 24 H 300 | EH 30024 | 6F | F32 | 24 | 97,02 | 95,65 | 93 | 75 | - | 84 | 94 | - | 15 | 45 | 4,70 |
| | | 26 H 300 | EH 30026 | 6CWF | F34 | 26 | 105,11 | 103,73 | 102 | 55 | 81 | 84 | 92 | 24 | 15 | 32 | 3,30 |
| | | 28 H 300 | EH 30028 | 6CWF | F36 | 28 | 113,19 | 111,82 | 120 | 60 | 88 | 84 | 92 | 24 | 15 | 35 | 3,60 |
| | | 30 H 300 | EH 30030 | 6CWF | F38 | 30 | 121,28 | 119,90 | 128 | 60 | 97 | 84 | 92 | 24 | 15 | 35 | 4,20 |
| | | 32 H 300 | EH 30032 | 6CWF | F40 | 32 | 129,36 | 127,99 | 135 | 70 | 105 | 84 | 92 | 19 | 20 | 40 | 4,30 |
| | | 36 H 300 | EH 30038 | 6CWF | F42 | 36 | 145,53 | 144,16 | 150 | 80 | 118 | 84 | 92 | 19 | 20 | 45 | 5,20 |
| GHISA CAST IRON GRAUGUSS FONTE HIERRO FUNDIDO | SENZA FLANGIA WITHOUT FLANGES OHNE FLANSCHEN SANS FLASQUES SINTAPETAS | 40 H 300 | EH 30040 | 11AF | F48 | 40 | 161,70 | 160,33 | 168 | 80 | 135 | 84 | 55 | - | 20 | 45 | 5,60 |
| | | 44 H 300 | EH 30044 | 11AF | F52 | 44 | 177,87 | 176,50 | 184 | 80 | 150 | 84 | 55 | - | 20 | 45 | 5,90 |
| | | 48 H 300 | EH 30048 | 11AF | F56 | 48 | 194,04 | 192,67 | 200 | 80 | 170 | 84 | 55 | - | 20 | 48 | 6,60 |
| | | 60 H 300 | EH 30060 | 11A | | 60 | 242,55 | 241,18 | - | 85 | 216 | 86 | 55 | - | 20 | 50 | 9,90 |
| | | 72 H 300 | EH 30072 | 11A | | 72 | 291,06 | 289,69 | - | 85 | 263 | 86 | 55 | - | 20 | 50 | 13,00 |
| | | 84 H 300 | EH 30084 | 11A | | 84 | 339,57 | 338,20 | - | 85 | 312 | 86 | 55 | - | 20 | 50 | 15,10 |
| | | 96 H 300 | EH 30096 | 11A | | 96 | 338,08 | 386,71 | - | 85 | 360 | 86 | 55 | - | 20 | 50 | 18,20 |
| | | 120 H 300 | EH 30120 | 10A | | 120 | 485,10 | 483,73 | - | 85 | 458 | 86 | 65 | - | 24 | 57 | 26,00 |

Pulegge per cinghie dentate tipo export
Timing belt pulleys for export
Zahnriemenscheiben für export
Poulies pour courroies dentées pour exportation
Poleas para correas para exportacion

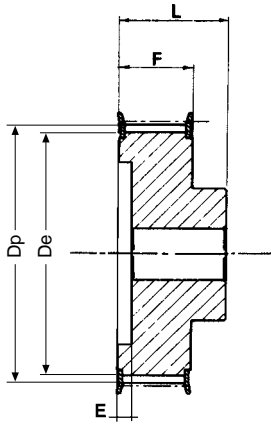

TIPO TYPE 6 CF

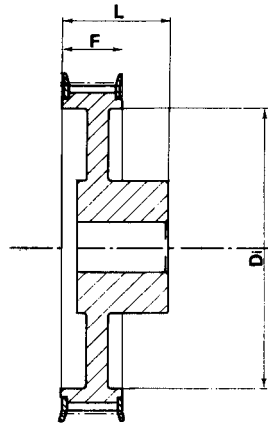

TIPO TYPE 6CWF

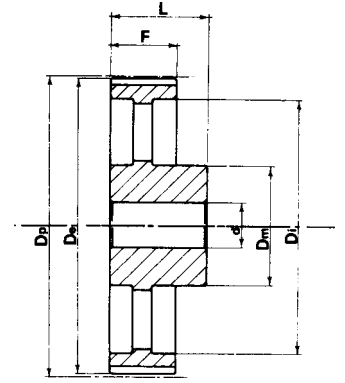

TIPO TYPE 6A

XH 200 - 7/8" (22,225 mm)

| CARATTERISTICHE FEATURES MERKMALE CARACTERISTIQUES CARACTERISTICAS | | CODICE CODE SYMBOL FABRIKNUMMER CODE SYMBOLE NUMERO DE FABRICA | NOSTRO CODICE OUR CODE UNSER KODE NOTRE CODE NUESTRO CODIGO | TIPO TYPE TYP TYPE TIPO | TIPO FLANGIA FLANGES TYPE BORDSCHE IBEN TYP TYPE FLASQUES TIPO TAPETAS | N. DENTI N. OF TEETH ZAHNEZAHL N. BRE DE DENTS CANTIDAD DE DIENTES | Dp | De | Df | Dm | Di | F | L | E | FORO STOCK STOCK BORE VOR BOHRUNG ALESAGE EN STOCK AGUJERO DE STOCK | FORO MAX MAX. BORE MAX BOHRUNG ALESAGE EN MAX AGUJERO DE MAX | PESO WEIGHT POIDS PESO Kg |
|--|--|---|--|-------------------------------------|---|--|--------|--------|--------|--------|-----|-----|-----|----|--|---|---------------------------------------|
| ACCIAIO STEEL STAHL ACIER ACERO | CON FLANGIA WITH FLANGES MIT FLANGES AVEC FLASQUES CON TAPETAS | 18 XH 200 | EXH2018 | 6CF | F44 | 18 | 127.34 | 124.55 | 140 | 85 | - | 65 | 78 | 18 | 20 | 50 | 4,80 |
| | | 20 XH 200 | EXH2020 | 6CF | F49 | 20 | 141.49 | 138.69 | 154 | 95 | - | 65 | 78 | 18 | 20 | 55 | 5,90 |
| | | 22 XH 200 | EXH2022 | 6CF | F52 | 22 | 155.74 | 152.84 | 168 | 110 | - | 65 | 78 | 18 | 20 | 65 | 7,40 |
| | | 24 XH 200 | EXH2024 | 6CF | F55 | 24 | 169.79 | 166.99 | 184 | 125 | - | 65 | 78 | 18 | 25 | 70 | 8,70 |
| | | 26 XH 200 | EXH2026 | 6CF | F59 | 26 | 183.9 | 181,14 | 200 | 140 | - | 65 | 78 | 18 | 25 | 70 | 10,40 |
| | | 28 XH 200 | EXH2028 | 6CWF | F61 | 28 | 198.08 | 195.29 | 212 | 120 | 156 | 65 | 78 | 18 | 25 | 70 | 10,00 |
| | | 30 XH 200 | EXH2030 | 6CWF | F62 | 30 | 213.2 | 209,44 | 226 | 120 | 170 | 65 | 78 | 18 | 25 | 70 | 11,00 |
| | | 32 XH 200 | EXH2032 | 6CWF | F64 | 32 | 226.4 | 223,59 | 240 | 130 | 184 | 65 | 78 | 18 | 25 | 75 | 13,00 |
| | | 40 XH 200 | EXH2040 | 6CWF | F70 | 40 | 282.98 | 280,18 | 296 | 140 | 241 | 65 | 78 | 18 | 25 | 80 | 17,00 |
| | | GHISA CAST IRON GRAUGUSS FONTE HIERRO FUNDIDO | SENZA FLANGIA WITHOUT FLANGES OHNE FLANSCHEN SANS FLASQUES SINTAPETAS | 48 XH 200 | EXH2048 | 6A | | 48 | 339.57 | 336,78 | - | 150 | 297 | 65 | 80 | - | 30 |
| 60 XH 200 | EXH2060 | | | 6A | | 60 | 424.47 | 421,67 | - | 150 | 382 | 65 | 80 | - | 30 | 85 | 24,00 |
| 72 XH 200 | EXH2072 | | | 6A | | 72 | 509.36 | 506,57 | - | 150 | 467 | 65 | 80 | - | 40 | 85 | 27,00 |
| 84 XH 200 | EXH2084 | | | 6A | | 84 | 594.25 | 591,46 | - | 160 | 552 | 65 | 80 | - | 40 | 90 | 34,10 |
| 96 XH 200 | EXH2096 | | | 6A | | 96 | 679.15 | 676,35 | - | 160 | 637 | 65 | 80 | - | 40 | 90 | 43,00 |
| 120 XH 200 | EXH2120 | | | 6A | | 120 | 848,93 | 846,14 | - | 160 | 806 | 65 | 80 | - | 40 | 90 | 54,20 |

XH 300 - 7/8" (22,225 mm)

| CARATTERISTICHE FEATURES MERKMALE CARACTERISTIQUES CARACTERISTICAS | | CODICE CODE SYMBOL FABRIKNUMMER CODE SYMBOLE NUMERO DE FABRICA | NOSTRO CODICE OUR CODE UNSER KODE NOTRE CODE NUESTRO CODIGO | TIPO TYPE TYP TYPE TIPO | TIPO FLANGIA FLANGES TYPE BORDSCHE IBEN TYP TYPE FLASQUES TIPO TAPETAS | N. DENTI N. OF TEETH ZAHNEZAHL N. BRE DE DENTS CANTIDAD DE DIENTES | Dp | De | Df | Dm | Di | F | L | E | FORO STOCK STOCK BORE VOR BOHRUNG ALESAGE EN STOCK AGUJERO DE STOCK | FORO MAX MAX. BORE MAX BOHRUNG ALESAGE EN MAX AGUJERO DE MAX | PESO WEIGHT POIDS PESO Kg |
|--|--|---|--|-------------------------------------|---|--|--------|--------|--------|--------|-----|------|-----|------|--|---|---------------------------------------|
| ACCIAIO STEEL STAHL ACIER ACERO | CON FLANGIA WITH FLANGES MIT FLANGES AVEC FLASQUES CON TAPETAS | 18 XH 300 | EXH3018 | 6CF | F44 | 18 | 127.34 | 124.55 | 140 | 85 | - | 90,5 | 78 | 18 | 20 | 50 | 4,80 |
| | | 20 XH 300 | EXH3020 | 6CF | F49 | 20 | 141.49 | 138.69 | 154 | 95 | - | 90,5 | 78 | 18 | 20 | 55 | 5,90 |
| | | 22 XH 300 | EXH3022 | 6CF | F52 | 22 | 155.74 | 152.84 | 168 | 110 | - | 90,5 | 78 | 18 | 20 | 65 | 7,40 |
| | | 24 XH 300 | EXH3024 | 6CF | F55 | 24 | 169.79 | 166.99 | 184 | 125 | - | 90,5 | 78 | 18 | 25 | 70 | 8,70 |
| | | 26 XH 300 | EXH3026 | 6CF | F59 | 26 | 183.9 | 181,14 | 200 | 140 | - | 90,5 | 78 | 18 | 25 | 70 | 10,40 |
| | | 28 XH 300 | EXH3028 | 6CWF | F61 | 28 | 198.08 | 195.29 | 212 | 120 | 156 | 90,5 | 78 | 18 | 25 | 70 | 10,00 |
| | | 30 XH 300 | EXH3030 | 6CWF | F62 | 30 | 213.2 | 209,44 | 226 | 120 | 170 | 90,5 | 78 | 18 | 25 | 70 | 11,00 |
| | | 32 XH 300 | EXH3032 | 6CWF | F64 | 32 | 226.4 | 223,59 | 240 | 130 | 184 | 90,5 | 78 | 18 | 25 | 75 | 13,00 |
| | | 40 XH 300 | EXH3040 | 6CWF | F70 | 40 | 282.98 | 280,18 | 296 | 140 | 241 | 90,5 | 78 | 18 | 25 | 80 | 17,00 |
| | | GHISA CAST IRON GRAUGUSS FONTE HIERRO FUNDIDO | SENZA FLANGIA WITHOUT FLANGES OHNE FLANSCHEN SANS FLASQUES SINTAPETAS | 48 XH 300 | EXH3048 | 10A | | 48 | 339.57 | 336,78 | - | 150 | 297 | 90,5 | 80 | - | 30 |
| 60 XH 300 | EXH3060 | | | 10A | | 60 | 424.47 | 421,67 | - | 150 | 382 | 90,5 | 80 | - | 30 | 85 | 24,00 |
| 72 XH 300 | EXH3072 | | | 10A | | 72 | 509.36 | 506,57 | - | 150 | 467 | 90,5 | 80 | - | 40 | 85 | 27,00 |
| 84 XH 300 | EXH3084 | | | 10A | | 84 | 594.25 | 591,46 | - | 160 | 552 | 90,5 | 80 | - | 40 | 90 | 34,10 |
| 96 XH 300 | EXH3096 | | | 10A | | 96 | 679.15 | 676,35 | - | 160 | 637 | 90,5 | 80 | - | 40 | 90 | 43,00 |
| 120 XH 300 | EXH3120 | | | 10A | | 120 | 848,93 | 846,14 | - | 160 | 806 | 90,5 | 80 | - | 40 | 90 | 54,20 |

Pulegge per cinghie dentate tipo export
Timing belt pulleys for export
Zahnriemenscheiben für export
Poulies pour courroies dentées pour exportation
Poleas para correas para exportacion

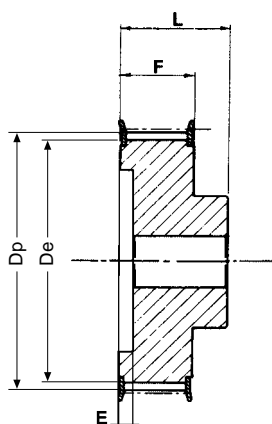

TIPO
TYPE 6 CF

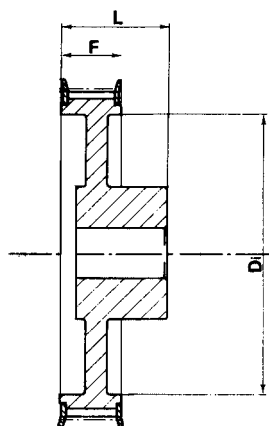

TIPO
TYPE 6CWF

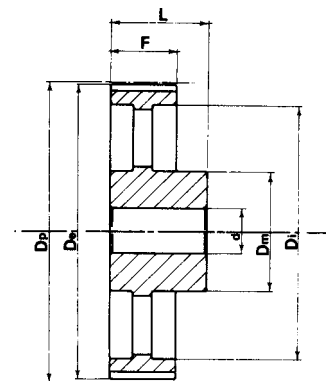

TIPO
TYPE 6A

XH 400 - 7/8" (22,225 mm)

| CARATTERISTICHE FEATURES MERKMALE CARACTERISTIQUES CARACTERISTICAS | | CODICE CODE SYMBOL FABRIKNUMMER CODE SYMBOLE NUMERO DE FABRICA | NOSTRO CODICE OUR CODE UNSER KODE NOTRE CODE NUESTRO CODIGO | TIPO TYPE TYP TYPE TIPO | TIPO FLANGIA FLANGES TYPE BORDSCHE IBEN TYP TYPE FLASQUES TIPO TAPETAS | N. DENTI N. OF TEETH ZAHNEZAHL N. BRE DE DENTS CANTIDAD DE DIENTES | Dp | De | Df | Dm | Di | F | L | E | FORO STOCK STOCK BORE VOR BOHRUNG ALESAGE EN STOCK AGUJERO DE STOCK | FORO MAX MAX. BORE MAX BOHRUNG ALESAGE EN MAX AGUJERO DE MAX | PESO WEIGHT GEWICHT POIDS PESO Kg |
|--|--|---|--|-------------------------------------|---|--|--------|--------|--------|--------|-----|-----|-----|-----|--|---|--|
| ACCIAIO STEEL STAHL ACIER ACERO | CON FLANGIA WITH FLANGES MIT FLANGES AVEC FLASQUES CON TAPETAS | 18 XH 400 | EXH4018 | 6CF | F44 | 18 | 127.34 | 124.55 | 140 | 85 | - | 118 | 78 | 18 | 20 | 50 | 4,80 |
| | | 20 XH 400 | EXH4020 | 6CF | F49 | 20 | 141.49 | 138.69 | 154 | 95 | - | 118 | 78 | 18 | 20 | 55 | 5,90 |
| | | 22 XH 400 | EXH4022 | 6CF | F52 | 22 | 155.74 | 152.84 | 168 | 110 | - | 118 | 78 | 18 | 20 | 65 | 7,40 |
| | | 24 XH 400 | EXH4024 | 6CF | F55 | 24 | 169.79 | 166.99 | 184 | 125 | - | 118 | 78 | 18 | 25 | 70 | 8,70 |
| | | 26 XH 400 | EXH4026 | 6CF | F59 | 26 | 183.9 | 181.14 | 200 | 140 | - | 118 | 78 | 18 | 25 | 70 | 10,40 |
| | | 28 XH 400 | EXH4028 | 6CWF | F61 | 28 | 198.08 | 195.29 | 212 | 120 | 156 | 118 | 78 | 18 | 25 | 70 | 10,00 |
| | | 30 XH 400 | EXH4030 | 6CWF | F62 | 30 | 213.2 | 209.44 | 226 | 120 | 170 | 118 | 78 | 18 | 25 | 70 | 11,00 |
| | | 32 XH 400 | EXH4032 | 6CWF | F64 | 32 | 226.4 | 223.59 | 240 | 130 | 184 | 118 | 78 | 18 | 25 | 75 | 13,00 |
| | | 40 XH 400 | EXH4040 | 6CWF | F70 | 40 | 282.98 | 280.18 | 296 | 140 | 241 | 118 | 78 | 18 | 25 | 80 | 17,00 |
| | | GHISA CAST IRON GRAUGUSS FONTE HIERRO FUNDIDO | SENZA FLANGIA WITHOUT FLANGES OHNE FLANSCHEN SANS FLASQUES SINTAPETAS | 48 XH 400 | EXH4048 | 6A | | 48 | 339.57 | 336.78 | - | 150 | 297 | 118 | 80 | - | 30 |
| 60 XH 400 | EXH4060 | | | 6A | | 60 | 424.47 | 421.67 | - | 150 | 382 | 118 | 80 | - | 30 | 85 | 24,00 |
| 72 XH 400 | EXH4072 | | | 6A | | 72 | 509.36 | 506.57 | - | 150 | 467 | 118 | 80 | - | 40 | 85 | 27,00 |
| 84 XH 400 | EXH4084 | | | 6A | | 84 | 594.25 | 591.46 | - | 160 | 552 | 118 | 80 | - | 40 | 90 | 34,10 |
| 96 XH 400 | EXH4096 | | | 6A | | 96 | 679.15 | 676.35 | - | 160 | 637 | 118 | 80 | - | 40 | 90 | 43,00 |
| 120 XH 400 | EXH4120 | | | 6A | | 120 | 848,93 | 846,14 | - | 160 | 806 | 118 | 80 | - | 40 | 90 | 54,20 |

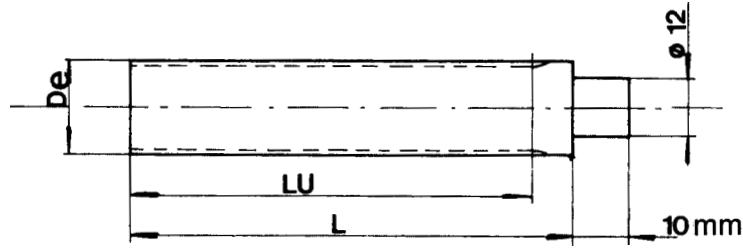

MXL - 0.080" (mm 2,032)

| CODICE CODE SYMBOL FABRIK- NUMMER CODE SYMBOLE NUMERO DE FABRICA | NOSTRO CODICE OUR CODE UNSER KODE NOTRE CODE NUESTRO CODIGO | N. DENTI N. OF TEETH ZÄHNEZAHL NOMBRE DE DENTS CANTIDAD DE DIENTES | De | LU | L |
|---|---|---|-------|-----|-----|
| | | | | | |
| MXL 10 | BMXL 010 | 10 | 5.97 | 50 | 75 |
| MXL 11 | BMXL 011 | 11 | 6.60 | 50 | 75 |
| MXL 12 | BMXL 012 | 12 | 7.26 | 50 | 75 |
| MXL 13 | BMXL 013 | 13 | 7.90 | 50 | 75 |
| MXL 14 | BMXL 014 | 14 | 8.56 | 50 | 75 |
| MXL 15 | BMXL 015 | 15 | 9.19 | 50 | 75 |
| MXL 16 | BMXL 016 | 16 | 9.83 | 50 | 75 |
| MXL 17 | BMXL 017 | 17 | 10.49 | 50 | 75 |
| MXL 18 | BMXL 018 | 18 | 11.12 | 50 | 75 |
| MXL 19 | BMXL 019 | 19 | 11.78 | 90 | 120 |
| MXL 20 | BMXL 020 | 20 | 12.42 | 90 | 120 |
| MXL 21 | BMXL 021 | 21 | 13.08 | 90 | 120 |
| MXL 22 | BMXL 022 | 22 | 13.72 | 125 | 140 |
| MXL 23 | BMXL 023 | 23 | 14.38 | 125 | 140 |
| MXL 24 | BMXL 024 | 24 | 15.01 | 125 | 140 |
| MXL 25 | BMXL 025 | 25 | 15.67 | 125 | 140 |
| MXL 26 | BMXL 026 | 26 | 16.31 | 125 | 140 |
| MXL 27 | BMXL 027 | 27 | 16.94 | 125 | 140 |
| MXL 28 | BMXL 028 | 28 | 16.70 | 125 | 140 |
| MXL 29 | BMXL 029 | 29 | 18.24 | 125 | 140 |
| MXL 30 | BMXL 030 | 30 | 18.90 | 125 | 140 |
| MXL 32 | BMXL 032 | 32 | 20.19 | 125 | 140 |
| MXL 34 | BMXL 034 | 34 | 21.49 | 125 | 140 |
| MXL 35 | BMXL 035 | 35 | 22.12 | 132 | 140 |
| MXL 36 | BMXL 036 | 36 | 22.78 | 132 | 140 |
| MXL 38 | BMXL 038 | 38 | 24.08 | 132 | 140 |
| MXL 40 | BMXL 040 | 40 | 25.37 | 132 | 140 |
| MXL 42 | BMXL 042 | 42 | 26.67 | 140 | 140 |
| MXL 44 | BMXL 044 | 44 | 27.94 | 140 | 140 |
| MXL 45 | BMXL 045 | 45 | 28.60 | 140 | 140 |
| MXL 48 | BMXL 048 | 48 | 30.53 | 140 | 140 |
| MXL 50 | BMXL 050 | 50 | 32.33 | 140 | 140 |
| MXL 60 | BMXL 060 | 60 | 38.30 | 160 | 160 |
| MXL 64 | BMXL 064 | 64 | 40.89 | 160 | 160 |
| MXL 65 | BMXL 065 | 65 | 41.53 | 160 | 160 |
| MXL 70 | BMXL 070 | 70 | 44.78 | 160 | 160 |
| MXL 72 | BMXL 072 | 72 | 46.05 | 160 | 160 |
| MXL 75 | BMXL 075 | 75 | 48.01 | 160 | 160 |
| MXL 90 | BMXL 090 | 90 | 57.71 | 160 | 160 |
| MXL 110 | BMXL 110 | 110 | 70.64 | 160 | 160 |

XL - 1/5" (mm 5,08)

| CODICE CODE SYMBOL FABRIK- NUMMER CODE SYMBOLE NUMERO DE FABRICA | NOSTRO CODICE OUR CODE UNSER KODE NOTRE CODE NUESTRO CODIGO | | N. DENTI N. OF TEETH ZÄHNEZAHL NOMBRE DE DENTS CANTIDAD DE DIENTES | De | LU | L |
|---|---|----------|---|--------|-----|-----|
| | AL. | C40 | | | | |
| XL 10 | BXLA 010 | BXLC 010 | 10 | 15.66 | 125 | 140 |
| XL 11 | BXLA 011 | BXLC 011 | 11 | 17.28 | 125 | 140 |
| XL 12 | BXLA 012 | BXLC 012 | 12 | 18.90 | 125 | 140 |
| XL 13 | BXLA 013 | BXLC 013 | 13 | 20.51 | 125 | 140 |
| XL 14 | BXLA 014 | BXLC 014 | 14 | 22.13 | 132 | 140 |
| XL 15 | BXLA 015 | BXLC 015 | 15 | 23.75 | 132 | 140 |
| XL 16 | BXLA 016 | BXLC 016 | 16 | 25.36 | 140 | 140 |
| XL 17 | BXLA 017 | BXLC 017 | 17 | 26.98 | 140 | 140 |
| XL 18 | BXLA 018 | BXLC 018 | 18 | 28.60 | 140 | 140 |
| XL 19 | BXLA 019 | BXLC 019 | 19 | 30.22 | 140 | 140 |
| XL 20 | BXLA 020 | BXLC 020 | 20 | 31.83 | 140 | 140 |
| XL 21 | BXLA 021 | BXLC 021 | 21 | 33.45 | 160 | 160 |
| XL 22 | BXLA 022 | BXLC 022 | 22 | 35.07 | 160 | 160 |
| XL 23 | BXLA 023 | BXLC 023 | 23 | 36.60 | 160 | 160 |
| XL 24 | BXLA 024 | BXLC 024 | 24 | 38.30 | 160 | 160 |
| XL 25 | BXLA 025 | BXLC 025 | 25 | 39.93 | 160 | 160 |
| XL 26 | BXLA 026 | BXLC 026 | 26 | 41.53 | 160 | 160 |
| XL 27 | BXLA 027 | BXLC 027 | 27 | 43.15 | 160 | 160 |
| XL 28 | BXLA 028 | BXLC 028 | 28 | 44.77 | 160 | 160 |
| XL 29 | BXLA 029 | BXLC 029 | 29 | 46.39 | 160 | 160 |
| XL 30 | BXLA 030 | BXLC 030 | 30 | 48.00 | 160 | 160 |
| XL 32 | BXLA 032 | BXLC 032 | 32 | 51.24 | 160 | 160 |
| XL 34 | BXLA 034 | BXLC 034 | 34 | 52.76 | 160 | 160 |
| XL 35 | BXLA 035 | BXLC 035 | 35 | 54.47 | 160 | 160 |
| XL 36 | BXLA 036 | BXLC 036 | 36 | 56.09 | 160 | 160 |
| XL 38 | BXLA 038 | BXLC 038 | 38 | 57.70 | 160 | 160 |
| XL 40 | BXLA 040 | BXLC 040 | 40 | 60.94 | 160 | 160 |
| XL 42 | BXLA 042 | BXLC 042 | 42 | 62.56 | 160 | 160 |
| XL 44 | BXLA 044 | BXLC 044 | 44 | 64.17 | 160 | 160 |
| XL 45 | BXLA 045 | BXLC 045 | 45 | 65.79 | 160 | 160 |
| XL 48 | BXLA 048 | BXLC 048 | 48 | 67.41 | 160 | 160 |
| XL 50 | BXLA 050 | BXLC 050 | 50 | 69.02 | 160 | 160 |
| XL 60 | BXLA 060 | BXLC 060 | 60 | 70.64 | 160 | 160 |
| XL 64 | BXLA 064 | BXLC 064 | 64 | 77.11 | 160 | 160 |
| XL 65 | BXLA 065 | BXLC 065 | 65 | 90.04 | 160 | 160 |
| XL 70 | BXLA 070 | BXLC 070 | 70 | 96.51 | 160 | 160 |
| XL 72 | BXLA 072 | BXLA 072 | 72 | 115.92 | 160 | 160 |

L - 3/8" (mm 9,525)

| CODICE CODE SYMBOL FABRIK- NUMMER CODE SYMBOLE NUMERO DE FABRICA | NOSTRO CODICE OUR CODE UNSER KODE NOTRE CODE NUESTRO CODIGO | | N. DENTI N. OF TEETH ZÄHNEZAHL NOMBRE DE DENTS CANTIDAD DE DIENTES | De | LU | L |
|---|---|----------|---|-------|-----|-----|
| | AL. | C40 | | | | |
| L 10 | BOLA 010 | BOLC 010 | 10 | 29.56 | 140 | 140 |
| L 11 | BOLA 011 | BOLC 011 | 11 | 32.59 | 140 | 140 |
| L 12 | BOLA 012 | BOLC 012 | 12 | 35.62 | 160 | 160 |
| L 13 | BOLA 013 | BOLC 013 | 13 | 38.65 | 160 | 160 |
| L 14 | BOLA 014 | BOLC 014 | 14 | 41.68 | 160 | 160 |
| L 15 | BOLA 015 | BOLC 015 | 15 | 44.72 | 160 | 160 |
| L 16 | BOLA 016 | BOLC 016 | 16 | 47.75 | 160 | 160 |
| L 17 | BOLA 017 | BOLC 017 | 17 | 50.78 | 160 | 160 |
| L 18 | BOLA 018 | BOLC 018 | 18 | 53.81 | 160 | 160 |
| L 19 | BOLA 019 | BOLC 019 | 19 | 56.84 | 160 | 160 |
| L 20 | BOLA 020 | BOLC 020 | 20 | 59.88 | 160 | 160 |
| L 21 | BOLA 021 | BOLC 021 | 21 | 62.91 | 160 | 160 |
| L 22 | BOLA 022 | BOLC 022 | 22 | 65.94 | 160 | 160 |
| L 23 | BOLA 023 | BOLC 023 | 23 | 68.97 | 160 | 160 |
| L 24 | BOLA 024 | BOLC 024 | 24 | 72.00 | 160 | 160 |
| L 27 | BOLA 027 | BOLC 027 | 27 | 81.10 | 160 | 160 |
| L 30 | BOLA 030 | BOLC 030 | 30 | 90.20 | 160 | 160 |

Le barre dentate XL e L sono costruite in acciaio UNI C 40 e in alluminio UNI 3571 TA 16, adatte alla anodizzazione. Le barre MXL sono costruite solo in alluminio.

The timing bars XL and L are made of steel UNI C 40 and of aluminium UNI 3571 TA 16, suitable for anodic treatment, whereas the bars MXL are made of aluminium only.

Die stangen XL und L sind aus stahl UNI C 40 und aluminium UNI 3571 TA 16 geeignet fuer anodischen oxydation. Die stangen MXL werden nur aus aluminium gefertigt.

Les barreaux dentes XL et L sont fabriqués en acier UNI C 40 et en aluminium UNI 3571 TA 16, apte au traitement anodi = que, tandis que les barreaux MXL ne sont fabriqués qu'en aluminium.

Las barras dentadas XL y L se construyen en acero UNI C 40 y en aluminio UNI 3571 TA 16 para la oxidacion anodica, mientras que las barras MXL solo se fabrican en aluminio.

Flangia - Flanges Bordscheiben - Flanges - Tapetas

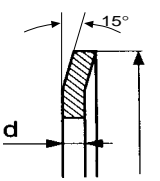
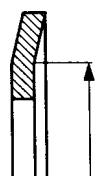
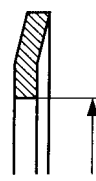

| N. DENTI N. OF TEETH ZÄHNEZAHL NOMBRE DE DENTS CANTIDAD DE DIENTES | FLANGIA - FLANGES - BORDSCHEIBEN - FLANGES - TAPETAS | | | | | | TIPO FLANGIA FLANGES TYPE BORDSCHEIBEN TYP TYPE FLANGES TIPO TAPETAS |  |  |  |
|---|--|-------------|---------------|---------------|-------------|-------------|--|--|---|---|
| | d = 0,5 mm | d = 1 mm | d = 1,5 mm | d = 1,5 mm | d = 3 mm | d = 3 mm | | | | |
| | MXL | XL | L | H | XH | XXH | | | | |
| 8 | - | - | - | - | - | - | F 01 | 13 | 10 | 6 |
| 9 | - | - | - | - | - | - | F 02 | 15 | 12 | 8 |
| 10 | - | F 07 | F 13 | - | - | - | F 03 | 16 | 13 | 9,5 |
| 11 | - | F 07 | F 13 | - | - | - | F 04 | 17,5 | 14,5 | 11,6 |
| 12 | - | F 08 | F 16 | - | - | - | F 05 | 18 | 15 | 11,5 |
| 13 | - | F 08 | F 17 | - | - | - | F 06 | 20 | 16,5 | 12,2 |
| 14 | - | F 09 | F 18 | F 24 | - | - | F 07 | 23 | 18 | 12,5 |
| 15 | - | F 09 | F 19 | F 25 | - | - | F 08 | 25 | 21,5 | 15 |
| 16 | F 02 | F 10 | F 20 | F 26 | - | - | F 09 | 28 | 24 | 17,8 |
| 17 | - | F 10 | F 21 | F 27 | - | - | F 10 | 32 | 27,5 | 23 |
| 18 | F 03 | F 11 | F 22 | F 28 | F 44 | F 58 | F 11 | 35 | 30,5 | 23 |
| 19 | - | F 11 | F 24 | F 29 | F 46 | F 60 | F 12 | 36 | 31 | 25 |
| 20 | F 03 | F 14 | F 25 | F 30 | F 49 | F 61 | F 13 | 37 | 33 | 25 |
| 21 | - | F 14 | F 26 | F 31 | F 51 | F 62 | F 14 | 38 | 34 | 26,5 |
| 22 | F 04 | F 15 | F 27 | F 32 | F 52 | F 64 | F 15 | 42 | 38 | 30,5 |
| 23 | - | - | F 28 | F 33 | - | - | F 16 | 43 | 39 | 31 |
| 24 | F 06 | F 17 | F 28 | F 34 | F 55 | - | F 17 | 44 | 40,5 | 32,5 |
| 25 | - | - | F 29 | F 35 | F 56 | - | F 18 | 48 | 43,5 | 37 |
| 26 | - | F 18 | F 30 | F 36 | F 59 | - | F 19 | 51 | 47 | 40 |
| 27 | - | F 18 | F 30 | F 37 | F 59 | - | F 20 | 54 | 50,5 | 43 |
| 28 | F 08 | F 19 | F 31 | F 38 | F 61 | - | F 21 | 57 | 52 | 46 |
| 29 | - | F 19 | F 32 | F 39 | - | - | F 22 | 60 | 57 | 47 |
| 30 | F 08 | F 24 | F 33 | F 40 | F 62 | - | F 23 | 61 | 56,5 | 49 |
| 31 | - | - | - | - | - | - | F 24 | 64 | 57 | 47 |
| 32 | F 08 | F 21 | F 34 | F 42 | F 64 | - | F 25 | 66 | 63 | 52 |
| 33 | - | - | F 35 | F 44 | - | - | F 26 | 70 | 66,5 | 53 |
| 34 | - | - | F 34 | F 48 | F 66 | - | F 27 | 75 | 68,5 | 60 |
| 35 | - | - | F 36 | F 48 | - | - | F 28 | 79 | 72,5 | 60 |
| 36 | F 09 | - | F 37 | F 48 | - | - | F 29 | 83 | 78 | 68 |
| 37 | - | - | - | - | - | - | F 30 | 87 | 82,5 | 72 |
| 38 | - | - | - | F 50 | F 69 | - | F 31 | 91 | 85,5 | 76 |
| 39 | - | - | - | - | - | - | F 32 | 93 | 89 | 80 |
| 40 | F 10 | - | F 40 | F 52 | F 70 | - | F 33 | 97 | 93,8 | 83 |
| 41 | - | - | F 41 | - | - | - | F 34 | 102 | 97 | 82,5 |
| 42 | F 10 | - | F 42 | F 53 | - | - | F 35 | 106 | 101 | 90 |
| 43 | - | - | - | - | - | - | F 36 | 112 | 105,5 | 91 |
| 44 | F 13 | - | F 45 | F 55 | - | - | F 37 | 115 | 109 | 94 |
| 45 | - | - | F 45 | F 57 | - | - | F 38 | 120 | 112,5 | 99,5 |
| 46 | - | - | - | - | - | - | F 39 | 123 | 117,5 | 107 |
| 47 | - | - | F 48 | - | - | - | F 40 | 128 | 124 | 107 |
| 48 | - | - | F 48 | F 59 | - | - | F 41 | 131 | 125,5 | 115 |
| 49 | - | - | - | - | - | - | F 42 | 135 | 128,5 | 115 |
| 50 | - | - | - | - | - | - | F 43 | 138 | 132 | 121 |
| 51 | - | - | - | - | - | - | F 44 | 140 | 125 | 107 |
| 52 | - | - | - | - | - | - | F 45 | 142 | 137 | 120 |
| 53 | - | - | - | - | - | - | F 46 | 146 | 133 | 107 |
| 54 | - | - | - | - | - | - | F 47 | 148 | 143 | 132 |
| 55 | - | - | - | - | - | - | F 48 | 150 | 145 | 130 |
| 56 | - | - | - | - | - | - | F 49 | 154 | 142 | 122 |
| 57 | - | - | - | - | - | - | F 50 | 158 | 153 | 138,5 |
| 58 | - | - | - | - | - | - | F 51 | 160 | 148 | 120 |
| 59 | - | - | - | - | - | - | F 52 | 168 | 161 | 148 |
| 60 | - | - | - | - | - | - | F 53 | 175 | 170 | 157 |
| 61 | - | - | - | - | - | - | F 54 | 180 | 174 | 154 |
| 63 | - | - | - | - | - | - | F 55 | 184 | 168 | 135 |
| 64 | - | - | - | - | - | - | F 56 | 188 | 176 | 150 |
| 65 | - | - | - | - | - | - | F 57 | 192 | 187 | 173 |
| 66 | - | - | - | - | - | - | F 58 | 198 | 180 | 150 |
| 67 | - | - | - | - | - | - | F 59 | 200 | 193 | 180 |
| 68 | - | - | - | - | - | - | F 60 | 205 | 189 | 160 |
| 69 | - | - | - | - | - | - | F 61 | 212 | 200 | 162 |
| 70 | - | - | - | - | - | - | F 62 | 226 | 214 | 190 |
| 71 | - | - | - | - | - | - | F 63 | 230 | 222 | 200 |
| 72 | - | - | - | - | - | - | F 64 | 240 | 224 | 192 |
| 73 | - | - | - | - | - | - | F 65 | 250 | 228 | 200 |
| 74 | - | - | - | - | - | - | F 66 | 256 | 240 | 220 |
| 75 | - | - | - | - | - | - | F 67 | 265 | 240 | 213 |
| 76 | - | - | - | - | - | - | F 68 | 275 | 253 | 225 |
| 77 | - | - | - | - | - | - | F 69 | 286 | 277 | 242 |
| 78 | - | - | - | - | - | - | F 70 | 296 | 287 | 260 |
| 79 | - | - | - | - | - | - | F 71 | 300 | 280 | 252 |
| 80 | - | - | - | - | - | - | F 72 | 325 | 305 | 278 |
| 81 | - | - | - | - | - | - | F 73 | 350 | 330 | 302 |
| 82 | - | - | - | - | - | - | F 74 | 375 | 355 | 328 |
| 83 | - | - | - | - | - | - | F 75 | 405 | 380 | 354 |
| 84 | - | - | - | - | - | - | F 76 | 430 | 406 | 380 |
| 85 | - | - | - | - | - | - | F 77 | 455 | 432 | 405 |
| 86 | - | - | - | - | - | - | F 78 | 480 | 457 | 430 |
| 87 | - | - | - | - | - | - | F 79 | 530 | 508 | 481 |
| 88 | - | - | - | - | - | - | F 80 | 595 | 572 | 544 |
| 89 | - | - | - | - | - | - | | | | |
| 90 | - | - | - | - | - | - | | | | |